

HTS Series High-voltage ignition Transformer

1. Outline:

HTS Series High-voltage ignition transformers are widely used in many installation's ignition such as small burners, fuel & gas burners, integrated burners, industrial combustion equipment etc.

2. Technical parameters:

	HTS-7	HTS□-8B	HTS□-10A
Input	Voltage: 220V/50Hz	Voltage: 220V/50Hz	Voltage: 220V/50Hz
	Current: ≤0.7A	Current: ≤1.1A	Current: ≤1.2A
Output	Voltage: ≥1x7KV or ≥2x4KV	Voltage: ≥1x8KV	Voltage: ≥2x5KV
	Current: ≥15mA	Current: ≥20mA	Current: ≥20mA
Outline dimension	92X70X57mm	110X86X68mm	110X86X68mm
Ignition distance	3~4mm	3~5mm	3~6mm
Ignition efficiency within 3 minutes	Interval time 20%	Interval time 33%	Interval time 33%
	Continuous -----	Continuous 100%	Continuous 100%
output type	Swingle polar、Bipolar	Swingle polar	Bipolar
output form	Lead wire	Lead wire/Plug-in unit	Lead wire/Plug-in unit
USE	Ignition of smaller burners ,fuel gas burners,integrated burners,industrial combustion equipment etc.		

3. Order description:

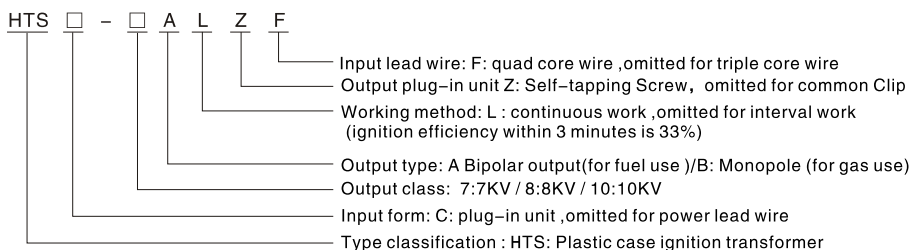

4. Product type table for chosen

Output voltage	Output type		Work type		Input form	Output form				
	Swingle	Bipolar	Continuous	Interval time		Plug-in unit	Lead wire	Self-tapping	omitted for common	triple core wire
7KV	√	√	X	√	X	√	√	√	√	√
8KV	√	X	√	√	√	√	√	√	√	√
10KV	X	√	√	√	√	√	X	√	√	X

√: Optional

X: Not optional

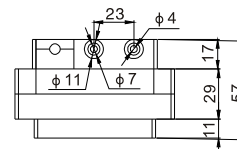

Technical parameters:

HTS-7A

Input: 220V, ≤0.7A, 50Hz
 Output: ≥2x4KV, 15mA
 Outline dimension: 92X70X57mm
 Ignition distance: 3~4mm
 Ignition efficiency within 3 minutes: 20%
 Output plug-in unit: Self-tapping
 Omitted for common

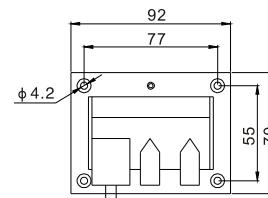

HTS-7B

Input: 220V, ≤0.7A, 50Hz
 Output: ≥1x7KV, 15mA
 Outline dimension: 92X70X57mm
 Ignition distance: 3~4mm
 Ignition efficiency within 3 minutes: 20%
 Output plug-in unit: Self-tapping
 Omitted for common

Note: The double color wire must be well grounded when you use the transformers

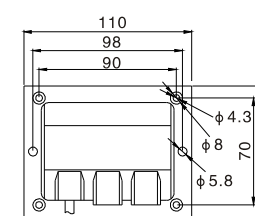
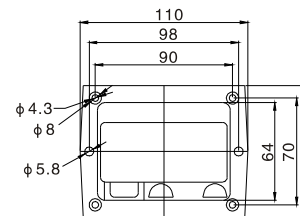
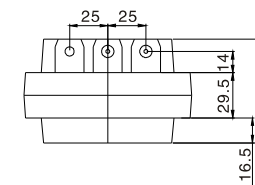
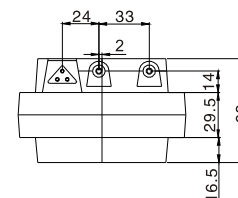

Note: The double color wire must be well grounded when you use the transformers

Technical parameters:

HTS-8B

Input: 220V, ≤1.1A, 50Hz
 Output: ≥1x8KV, 20mA
 Outline dimension: 110X86X68mm
 Ignition distance: 3~5mm
 Ignition efficiency within 3 minutes: 33%
 100%

HTS-10A

Input: 220V, ≤1.2A, 50Hz
 Output: ≥2x5KV, 20mA
 Outline dimension: 110X86X68mm
 Ignition distance: 3~6mm
 Ignition efficiency within 3 minutes: 33%

HTS-10AL

Input: 220V, ≤0.6A, 50Hz
 Output: ≥2x4KV, 15mA
 Outline dimension: 110X86X68mm
 Ignition distance: 3~6mm
 Ignition efficiency within 3 minutes: 100%

Input form: Plug-in unit

Lead wire

Output form: Self-tapping

Omitted for common

Input form: Plug-in unit

Lead wire

Output form: Plug-in unit

Lead wire

HT Series High-voltage ignition Transformer

1. Outline:

HT Series high voltage ignition transformers are widely used in many kinds of installation's ignition such as kitchen equipment burners, small burners, fuel & gas burners, tunnel kiln burners, integrated burners, radiant tube burners, high velocity burners, industrial furnace etc.

2. Technical parameters:

	HT-6	HT-8	HT-10	HT-14
Input	Voltage: 220V/50Hz	Voltage: 220V/50Hz	Voltage: 220V/50Hz	Voltage: 220V/50Hz
	Current: ≤0.7A	Current: ≤1.1A	Current: ≤1.2A	Current: ≤1.8A
Output	Voltage: ≥1x6KV	Voltage: ≥1x8KV	Voltage: ≥2x5KV	Voltage: ≥2x7KV
	Current: ≥15mA	Current: ≥20mA	Current: ≥20mA	Current: ≥25mA
Outline dimension	82X69X67mm	100X92X73mm	100X92X73mm	100X92X73mm
Ignition distance	2~3mm	3~5mm	3~5mm	4~6mm
Ignition efficiency within 3 minutes	Interval time 33%	Interval time 33%	Interval time 33%	Interval time 25%
	Continuous -----	Continuous 100%	Continuous 100%	Continuous -----
output type	Swingle polar、Bipolar	Swingle polar、Bipolar	Bipolar	Bipolar
output form	Lead wire/Plug-in unit	Lead wire/Plug-in unit	Lead wire/Plug-in unit	Lead wire/Plug-in unit
USE	many kinds of installation's ignition such as kitchen equipment burners, small burners, fuel & gas burners, tunnel kiln burners	Ignition of smaller burners, fuel gas burners, integrated burners, industrial combustion equipment etc.		

3. Order description:

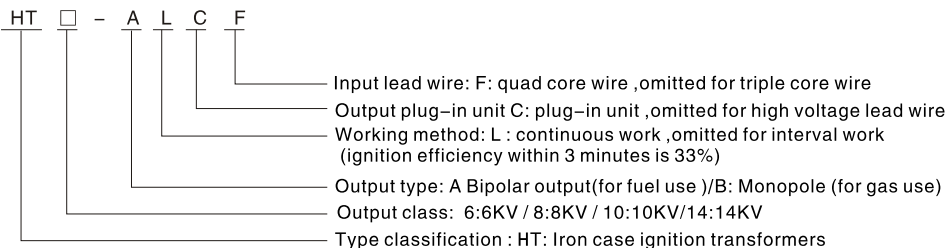

4. Product type table for chosen

Output voltage	Output type		Work type		Output form		Input lead wire	
	Swingle	Bipolar	Continuous	Interval time	Plug-in unit	Lead wire	triple core wire	quad core wire
6KV	✓	✓	x	✓	✓	✓	✓	✓
8KV	✓	x	✓	✓	✓	✓	✓	✓
10KV	x	✓	✓	✓	✓	✓	✓	✓
14KV	x	✓	x	✓	✓	✓	✓	x

✓: Optional x: Not optional

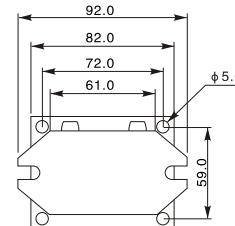
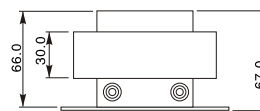

Note: The double color wire must be well grounded when you use the transformers

Technical parameters:

HT-6A □ □
 Input: 220V, ≤0.7A, 50Hz
 Output: ≥6KV, 15mA
 Outline dimension: 82X69X67mm
 Ignition distance: 2~3mm
 Ignition efficiency within 3 minutes: 33%
 Output form: Plug-in unit
 Lead wire

HT-6B □ □
 Input: 220V, ≤0.7A, 50Hz
 Output: ≥6KV, 15mA
 Outline dimension: 82X69X67mm
 Ignition distance: 2~3mm
 Ignition efficiency within 3 minutes: 33%
 Output form: Plug-in unit
 Lead wire

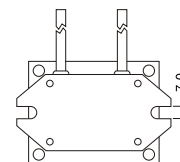
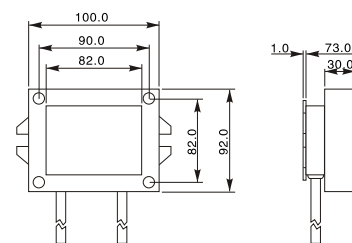

Note: The double color wire must be well grounded when you use the transformers

Technical parameters:

HT-8A □ □ □
 Input: 220V, ≤1.1A, 50Hz
 Output: ≥1x8KV, 20mA
 Outline dimension: 100X92X73mm
 Ignition distance: 3~5mm
 Ignition efficiency within 3 minutes: 33%/100%
 Input form: Plug-in unit
 Lead wire

HT-8B □ □ □
 Input: 220V, ≤1.1A, 50Hz
 Output: ≥1x8KV, 20mA
 Outline dimension: 100X92X73mm
 Ignition distance: 3~5mm
 Ignition efficiency within 3 minutes: 33%/100%
 Input form: Plug-in unit
 Lead wire

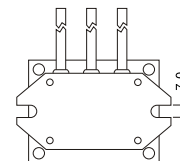
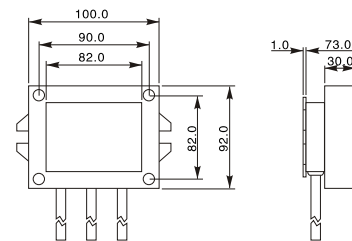

Note: The double color wire must be well grounded when you use the transformers

Technical parameters:

HT-10A □ □ □
 Input: 220V, ≤1.2A, 50Hz
 Output: ≥2x5KV, 20mA
 Outline dimension: 100X92X73mm
 Ignition distance: 3~5mm
 Ignition efficiency within 3 minutes: 33%/100%
 Input form: Plug-in unit
 Lead wire

HT-14A □
 Input: 220V, ≤1.8A, 50Hz
 Output: ≥2x7KV, 25mA
 Outline dimension: 100X92X73mm
 Ignition distance: 4~6mm
 Ignition efficiency within 3 minutes: 25%
 Input form: Plug-in unit
 Lead wire

Electronic series high voltage ignition transformers

1. Outline:

Electronic series high voltage ignition transformers are widely used in many installations such as Auto heater, ignition of kitchen equipment ,fuel&gas heater etc .

2. Technical parameters:

	HT-12	□□-12	□□-24
Input	Voltage: 220V/50Hz	Voltage: 12V/DC	Voltage: 24V/DC
	Current: ≤0.2A	Current: ≤3A	Current: ≤1.5A
Output	Voltage: ≥1x12KV	Voltage: ≥1x14KV	Voltage: ≥1x15KV
	Current: ≥10mA	Current: ≥10mA	Current: ≥10mA
Outline dimension	70X52X61mm	83X74X37mm	110X62X60mm 95X80X62mm 83X74X37mm
Ignition distance	3~5mm	3~5mm	3~6mm
Ignition efficiency within 3 minutes	Interval time 33%	Interval time 33%	Interval time 33%
	Continuous 100%	Continuous ---	Continuous 100%
output type	Swingle polar、 Bipolar	Bipolar	Swingle polar、 Bipolar
USE	Ignition of Auto heater, ignition of kitchen equipment, fuel&gas heater etc		

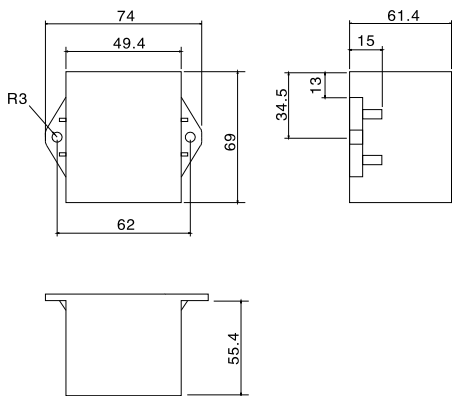

Technical parameters:

HT-12□□
 Input: 220V, ≤0.38A, 50Hz
 Output: ≥12KV
 Outline dimension: 70X52X61mm
 Ignition distance: 3~6mm
 Ignition efficiency within 3 minutes: HT-12□: 33%
 HT-12□L: 100%

Output type: Monopole ,Bipolar, XT-12A is bipolar output, two high-voltage wires outputted directly, suitable for fuel ignition;
 XT-12B is monopole ,there is only one output high-voltage wire used for high-voltage output, low point of the high-voltage directly grounded through one double colour wire ,suitable for gas ignition

Note:The double color wire must be well grounded when you use the transformers

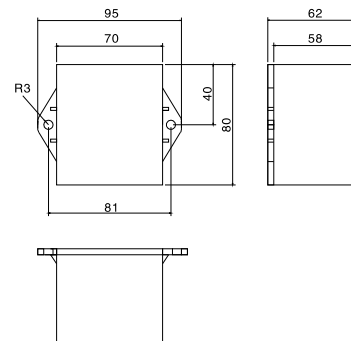

Technical parameters:

HTZ-24V
 Input: 24VDC, continuous ignition 0.4~0.5A,
 interval ignition 0.8~1.2A
 Output: ≥15KV
 Outline dimension: 95X80X62mm
 Ignition distance: 3~5mm
 Ignition efficiency within 3 minutes: 33%/100%

Note:The double color wire must be well grounded when you use the transformers

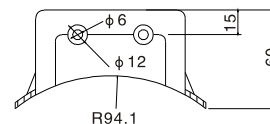

Technical parameters:

HNF-24
 Input: 24VDC, 0.8~1.2A
 Output: ≥15KV
 Outline dimension: 116X62X60mm
 Ignition distance: 3~5mm
 Ignition efficiency within 3 minutes: 33%

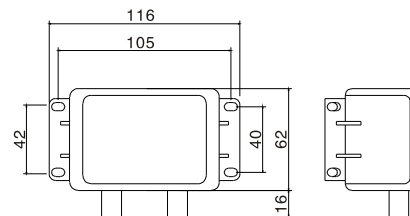

Note:The double color wire must be well grounded when you use the transformers

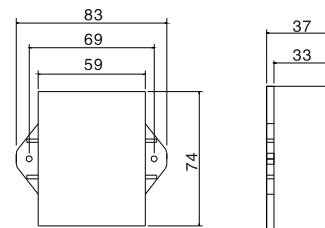

Technical parameters:

HTX-24V
 Input: 24VDC, ≤0.8A
 Output: ≥14KV
 Outline dimension: 83X74X37mm
 Ignition distance: 3~5mm
 Ignition efficiency within 3 minutes: 33%

Note:The double color wire must be well grounded when you use the transformers